



Ancient City Baptist Church is
ever ancient, ever new.

We embrace the wonderful
heritage that has been passed
down to us, and with gratitude
we prepare for the future.

Our 130+ year journey is not yet
complete! We desire to impact
our community and our world
with the gospel of Jesus until he
comes again for his church.



PROJECTS

Some of the areas we are addressing
in ***Ever Ancient, Ever New***

- ❖ Fellowship Hall
- ❖ Welcome Center
- ❖ Choir Suite
- ❖ Sanctuary sound and lights
- ❖ Elevator
- ❖ Signage
- ❖ Landscaping
- ❖ Covered walkway
- ❖ Improved parking for those
with limited mobility

Ancient City
BAPTIST CHURCH

27 Sevilla St., Saint Augustine, FL 32084

(904) 829-3476

www.ancientcitybaptist.org



Ancient City
BAPTIST CHURCH

***Pursuing Life in Christ
with Passion and Purpose***



“Late have I loved you, O Beauty,
ever ancient, ever new,
late have I loved you...”
Saint Augustine, *Confessions*



Providing for Ongoing Needs

King Joash said to the priests, "All the... silver voluntarily given for the LORD's temple— each priest is to take it... and repair whatever damage is found in the temple..."

Then the priest Jehoiada took a chest, bored a hole in its lid, and set it beside the altar...; the priests... put into the chest all the silver that was brought to the LORD's temple. Whenever they saw there was a large amount of silver in the chest, the king's secretary and the high priest... would give the weighed silver to those doing the work... and for all expenses for temple repairs. (From 2 Kings 12)

Maintenance, upgrade, and repair—these activities do not always grab our attention, yet they are necessary and must be accomplished. We ask you to bring sacrificial offerings as we seek to remain **ever ancient, ever new**. Take a look at some examples of the projects we are undertaking...



Jesus said, "Love your neighbor as yourself." (Mark 12.31)

The **Welcome Center** (above) will make the first impression for many guests to our church. Opening the space up will be more welcoming and will provide a location for our hosts and greeters to make first contact.



"They devoted themselves to the apostles' teaching, to fellowship, to the breaking of bread, and to prayer" (Acts 2.42).

Fellowship Hall (at left) is one of our most used spaces. All the activities practiced by early Christians as noted in the passage above—and more—take place in our primary "living room." Opening it up and modernizing this room will enhance our ability to fellowship and minister with a variety of groups in our church and community.



Improving access for those with limited mobility

We provide parking for those with limited mobility in the smaller back parking lot adjacent to the building. It is across the street from our Carrera St. parking lot, and the covered walkway and pavers will facilitate access to our Welcome Center and Sanctuary.

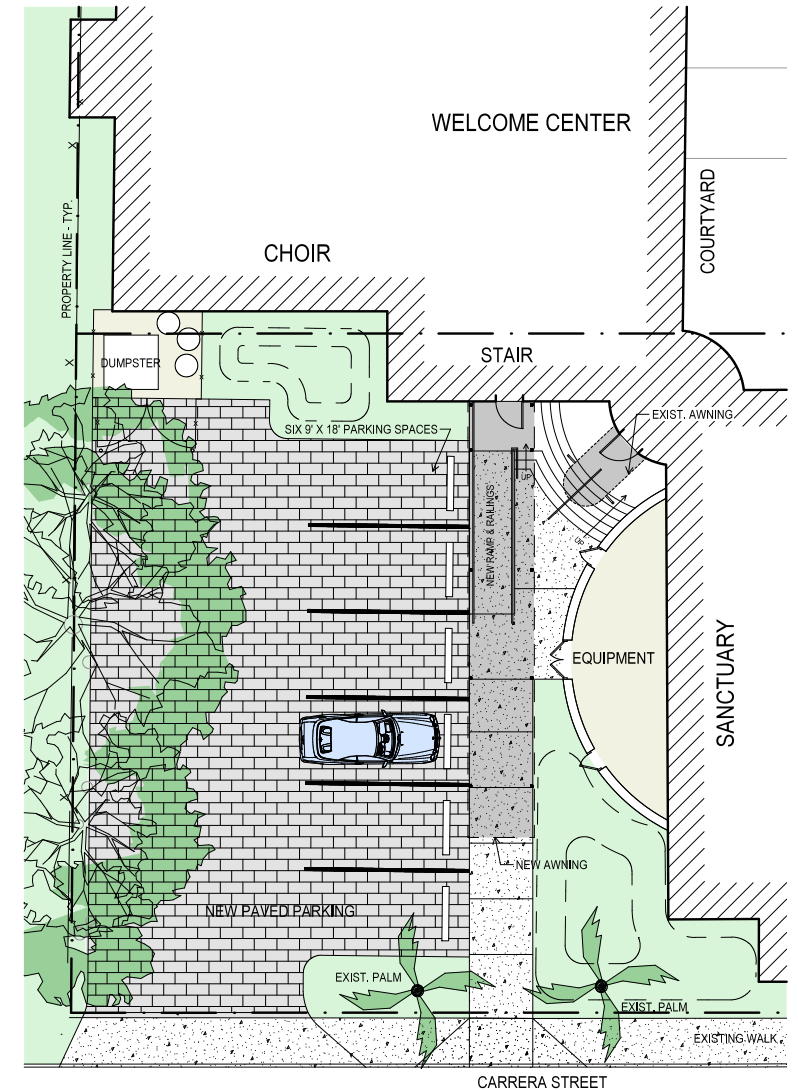

PARTIAL SITE PLAN
ANCIENT CITY BAPTIST CHURCH RENOVATIONS
KENNETH SMITH ARCHITECTS INC.

1/8"=1'-0"
4-5-2019